

IntelliStage

Portable Stage System

by Road Ready

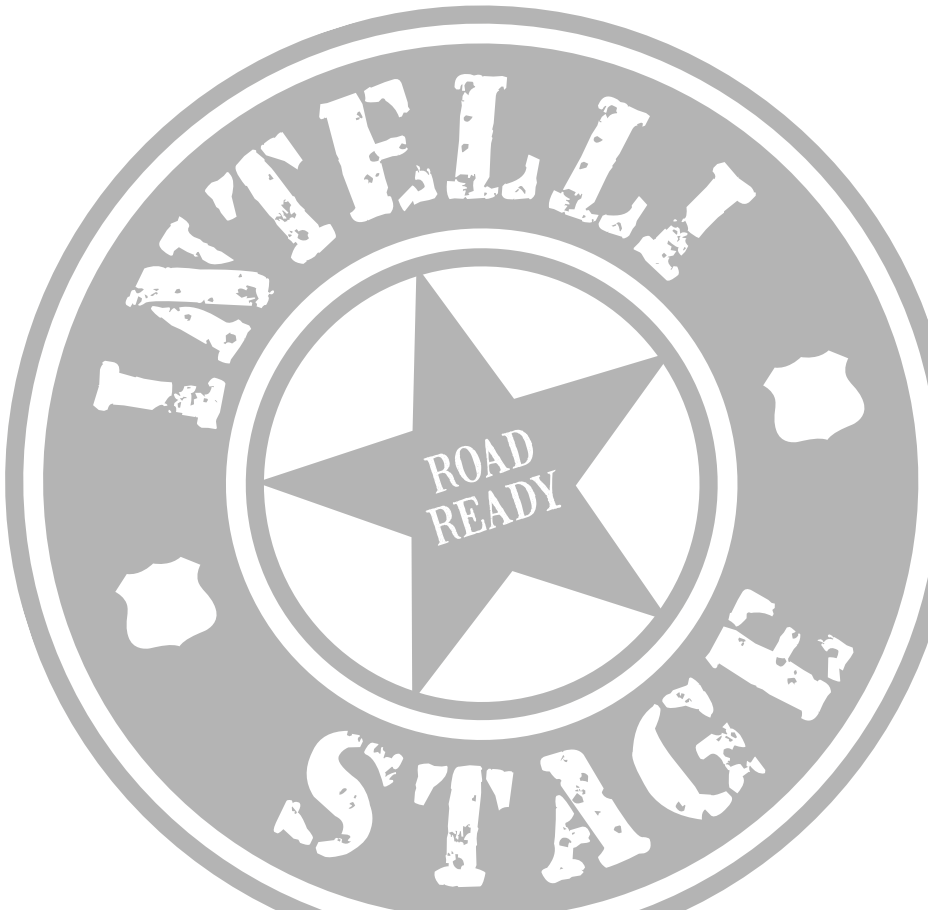

Features:

Platforms:

- Lightweight and compact for easy setup, transport and storage
- Durable grey carpet or DuraFlex finish
- Multiple layer platform construction featuring honeycomb structure with a weight capacity of up to 185 lbs./sq. ft (900 kg/sq. meter)
- Convenient cable and electrical ports on square and rectangular platforms
- Integrated platform interlocking system
- Metal reinforced corners

Risers:

- Universal, collapsible lightweight risers available in standard height configurations.

Specifications:

Since we are continually improving and refining products, specifications are subject to change without notice.

Platforms:

- Finish:
- Grey carpet
 - Duraflex

- Materials:
- Multiple layer sandwich construction
 - Top: 9 mm high density plywood
 - Middle: 7.5 mm honeycomb
 - Bottom: 4 mm high-density plywood
 - Aluminum profile on all sides with integrated platform interlocking system

Sizes: See page 10 (U.S.) and 12 (European)

Risers:

- Finish:
- Brushed aluminum
- Materials:
- Aluminum
 - Copper
 - ABS Plastic

Dimensions (height): See page 10 (U.S.) and 12 (European)

Weight Capacity: 185 lbs per sq. foot/900kg per square meter

Storage:

When storing your stage system, be sure to heed the arrows on the bottom of the platforms. This is to ensure that the panel interlocking devices are not damaged.

Recommended platform storage position

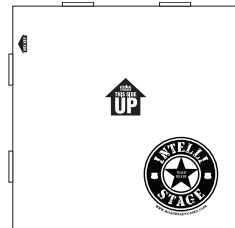

Important Safety Instructions:



- 1.) Read and follow these instructions
- 2.) Do not exceed the maximum weight capacity
- 3.) Do not vertically couple more than 2 risers
- 4.) Completely secure all fasteners
- 5.) Assemble and use on flat surface only

Meet the Components:

Putting together your **IntelliStage** system was designed to be simple enough for anyone to do easily. Consequently, the number of components you will encounter in the assembly process are limited. Nonetheless, let's take a moment for a little meet and greet...

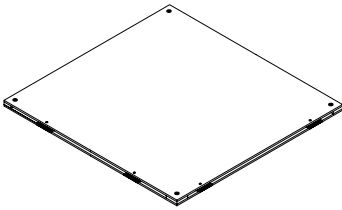

A.) Platform

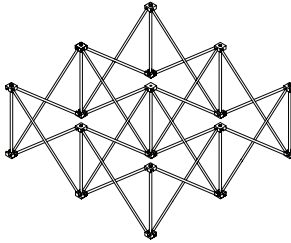

B.) Riser

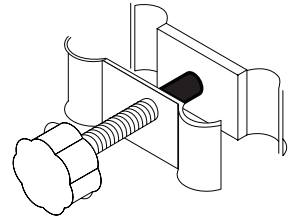

C.) Riser Clamp

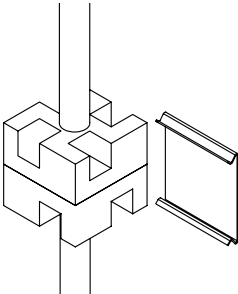

D.) Riser Coupler

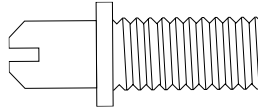

E.) Coupling Post



F.) Hex Key

A.) Platform

Durable, modular stage surface - supports up to 185 lbs./sq. ft. (900kg/sq. meter).

B.) Riser

Supports platform surface - available in 8", 16", 24" and 32" (20, 30, 40 & 60 cm.) heights.

C.) Riser Clamp

Provides support in situations where you would like to secure risers of different heights. Device is also used to secure steps to each other, as well as to risers.

D.) Riser Coupler

Allows you to extend the height of your platform by coupling a pair of existing risers. **Caution: For safety reasons, do not couple more than 2 levels of risers.**

E.) Coupling Post

Used when coupling one riser on top of another for added height. Adds additional support and stability.

F.) Hex Key

Probably the only tool other than a screwdriver you'll need to put your stage system together.

Assembly 101

Getting your stage system up and running has never been easier than this. You are literally minutes away from having a sturdy, professional presentation platform.

- Unpack your platform and risers.
- Expand riser completely
- Align corner locking posts on riser with corner holes on platform
- Lock platform to riser by turning the locking screws clockwise with the included hex key until tightly secured.
- To assemble steps, follow the same procedure.

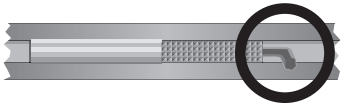
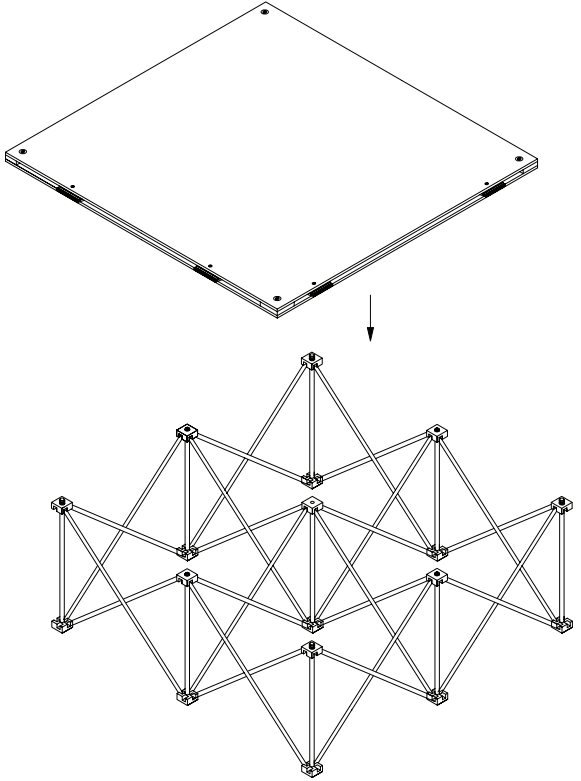

Note: You'll find your hex key in the foam key holder in the groove next to the platform locking mechanism indicated by the arrow on the bottom of the platform.

What You'll Need:



Hex Key

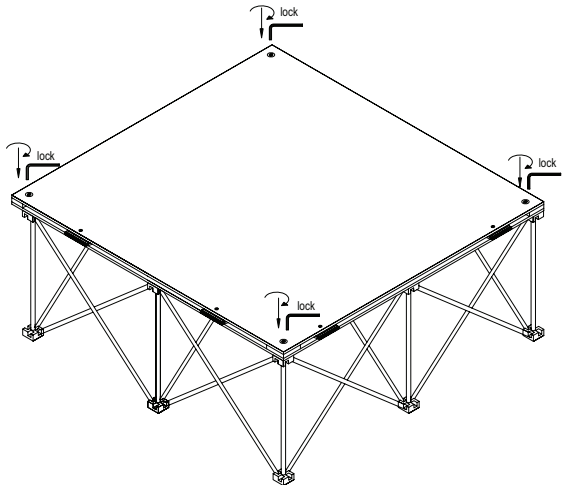

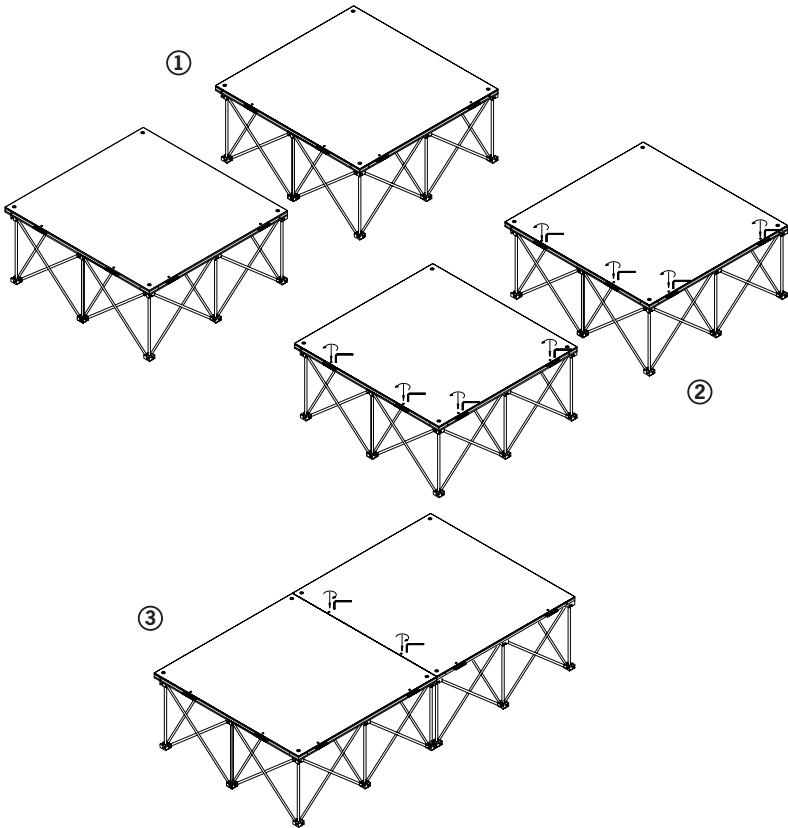

Securing Platforms

IntelliStage systems feature a unique, easy to use platform inter-locking system that ensures a safe, level performance surface.

- 1.) Expand risers completely and attach platforms as described in **Assembly 101**
- 2.) Make sure that the platform interlocking devices are in the closed position
- 3.) Insert male locking mechanism into groove on opposite platform and rotate locking screw clockwise. Repeat until your stage system is complete.

A Close-Up Look:



A.) Align Platforms

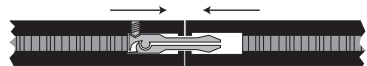

B.) Insert male locking mechanism

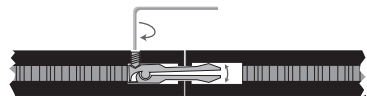

C.) Rotate locking screw clockwise

Securing Steps or Risers of Different Heights

When designing a custom stage configuration, you may encounter situations where you would like to use risers of different heights. Because the platform inter-locking mechanism will not work in this scenario, we've designed an alternate method that provides the same level of security. This is the same procedure that you would use when securing steps both to each other and to the stage risers.

- 1.) Expand and align risers. Mount stage platforms as described in **Assembly 101**.
- 2.) Loosen riser clamps by turning knob counter-clockwise.
- 3.) Secure riser clamps – 2 clamps per corner – by turning knob clockwise.

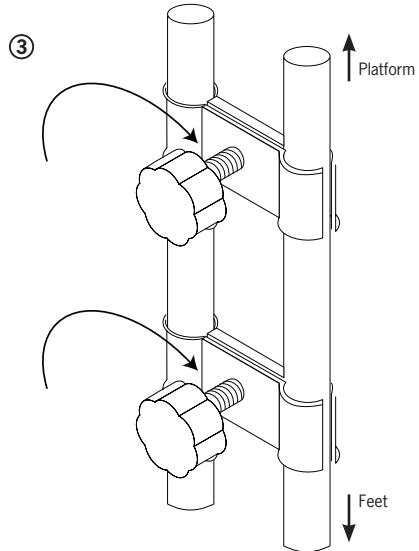
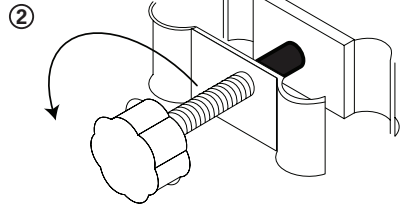
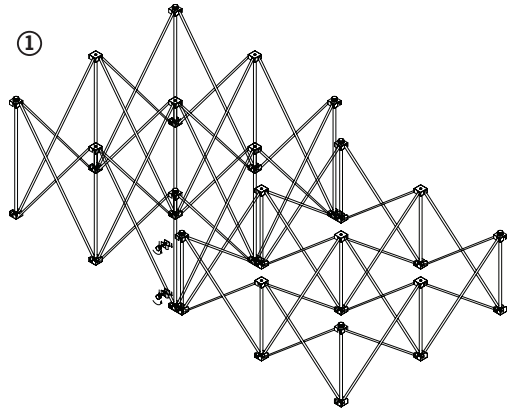

What You'll Need:

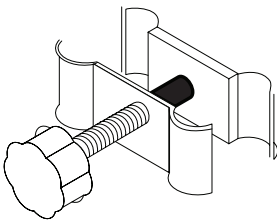

Riser Clamp